

ITEM SKU#: 662187512419

Dynamo 4 Pro

Stadium Flood Light

INDUSTRIAL LIGHTING | FLOOD LIGHTS



FEATURES

- Power selectability enables customized lighting levels for versatile applications.
- High-output illumination ensures powerful and uniform lighting across large arenas.
- Low EPA design reduces wind resistance, minimizing fixture stress and enhancing stability.
- Engineered for durability, the luminaire ensures reliable performance in challenging environments.
- Advanced dimming allows precise brightness control for optimal lighting.
- Built-in surge protection ensures enhanced reliability and stability during power fluctuations.
- DMX compatibility enables dynamic lighting control, including color-changing, grouping, scheduling, and remote operation.
- Optional visor and laser pointer for enhanced precision and glare control.

APPLICATIONS

Stadiums and Sports Venues, Outdoor Advertising, Gymnasiums, Plazas, Airports, Courtyards, Public Areas, Ports

PRODUCT DETAILS

ELECTRICAL

Max Power	1192.2W
Voltage	120-277V
Current	4.78A
Power Factor	0.9
Total Harmonic Distortion (THD)	15%
Surge Protection	L/N-PE: 10kV, L-N: 6kV

LIGHTING PERFORMANCE

Lumens	108352.5lm-144470lm-172240lm
Efficacy	144.47lm/W
Color Temperature (CCT)	5000K
Color Rendering (CRI)	71
R9 (Red Value)	-34
R13 (Skin Tones)	71
Beam Angle	20°
Light Distribution	NEMA:4 (NEMA:5/NEMA:6: Optional)
BUG Rating (Backlight, Uplight, and Glare)	B5-U0-G5
Dimmable Lighting Control	Continuous Dimming to 10% or Below

Notes:
 *Mentioned lumen output is calculated as such: 108352.5lm at 750W, 144470lm at 1000W, 172240lm at 1192.2W.
 *Fixtures mustn't be mounted facing upwards; it won't be covered under warranty.

ENVIRONMENT

Operating Temperature	-40°F ~ +113°F
Suitable Location	WET
Ingress Protection Rating (IP)	IP65
Impact Protection Rating (IK)	IK08

LIFESPAN

Average Life (Hours)	100,000
Warranty (Years)	10

COMPONENTS

LED Light Source	Bridgelux SMD3030
Driver	Inventronics EUM-680S350MT

CONSTRUCTION

Housing	Die-cast Aluminum
Cover Material / Lens	Polycarbonate
Diffuser	Clear
Power Supply	Hard Wired
Finish	Black (Bronze, White: Optional)
Effective Projected Area (EPA)	3.04ft²
Wind Sharing Rating	1.2mph

PART NUMBER & QUALIFICATIONS

Ordering Part Number	IK-SP06B-1200/1000/750W-E1PS2MV-50K-BL-SH-20SP-FM
Qualified Part Number	IK-SP06B-1200/1000/750W-E1PS2MV-[BR, WH, BL] [3RP, 3NP, 3NT, 5RP, 5NP, 5NT, 7RP, 7NP, 7NT or blank] [10SP, 20SP or blank][AM, FM or blank]50
SKU Number	662187512419



Not all product variations listed on this page are DLC qualified. Visit <https://www.designlights.org/qpl> to confirm qualification.

DIMENSIONS AND WEIGHT (SLIP FITTER MOUNT)

Width (Inches)	31.67"
Height (Inches)	30.06"
Diameter (Inches)	20.51"
Net Weight (lbs)	70.98

DIMENSIONS AND WEIGHT (FLOOD MOUNT)

Width (Inches)	31.67"
Height (Inches)	21.28"
Diameter (Inches)	20.51"
Net Weight (lbs)	62.04

PACKAGING

SLIP FITTER & FLOOD MOUNT

Box Dimensions (Inches)	27.16" x 24.01" x 24.21"
Box Weight (lbs)	84.66 (Slip Fitter Mount) 75.68 (Flood Mount)
Quantity Per Box	1

Slip Fitter Mount

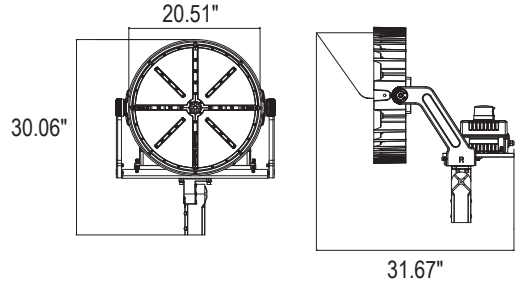

Flood Mount

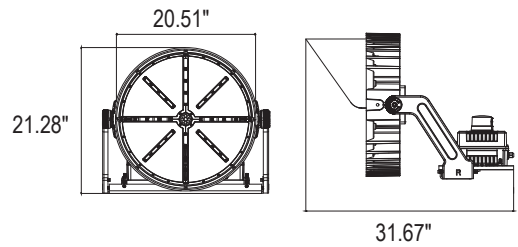

SUPPORTING DOCUMENTS

DOCUMENTS	DOCUMENT LINK
Product Sheet	View / Download
IES Files	View / Download
LM79 Report	View / Download
LM80 Report	View / Download
Installation Instructions	View / Download

ORDERING INFORMATION

SKU NUMBER	DESCRIPTION	QUANTITY/BOX
662187512419	DYNAMO 4 PRO SFL: 1192.2W / 108352.5-144470-172240LM / 5000K / 120-277V / BLACK	1

ACCESSORIES

INCLUDED IN THE BOX

SKU NUMBER	PRODUCT CODE	DESCRIPTION	DOCUMENT LINK
662187507651	IK-ACC-SP06B-750/1000/1200W-FM	FLOOD MOUNTING BRACKET	View / Download
662187507743	IK-ACC-SP06B-750/1000/1200W-SH	SHIELD	View / Download
662187487625	IK-ACC-SPD-20KV-(100-277V)	SURGE PROTECTION 20kV (100-277V)	View / Download

ACCESSORIES

SOLD SEPARATELY

SKU NUMBER	PRODUCT CODE	DESCRIPTION	DOCUMENT LINK
662187507651	IK-ACC-SP06B-750/1000/1200W-FM	FLOOD MOUNTING BRACKET	View / Download
662187487946	IK-ACC-SP06B-300-1200-SF	SLIP FITTER MOUNTING BRACKET	View / Download
662187507743	IK-ACC-SP06B-750/1000/1200W-SH	SHIELD	View / Download
662187482231	IK-PHC-3PIN-AC100-277V	PHOTOCELL (3 PIN) AC100-277V	View / Download
662187540160	IK-PHC-5PIN-AC100-277V	PHOTOCELL (5 PIN) AC100-277V	View / Download
662187540177	IK-PHC-7PIN-AC100-277V	PHOTOCELL (7 PIN) AC100-277V	View / Download
662187483634	IK-PHC-3PIN-SOCKET-0-480V	PHOTOCELL (3 PIN) SOCKET AC 0-480V	View / Download
662187483641	IK-PHC-5PIN-SOCKET-0-480V	PHOTOCELL (5 PIN) SOCKET AC 0-480V	View / Download
662187487755	IK-PHC-7PIN-SOCKET-0-480V	PHOTOCELL (7 PIN) SOCKET AC 0-480V	View / Download
662187486543	IK-ACC-SPD-10KV-(100-277V)	SURGE PROTECTION 10kV (100-277V)	View / Download
662187487625	IK-ACC-SPD-20KV-(100-277V)	SURGE PROTECTION 20kV (100-277V)	View / Download

*Choice of one accessory: Mounting Bracket (Slip Fitter or Flood Mount—either one) is included with the order. Contact your IKIO sales representative to buy replacement/additional Mounting Bracket.

NOTE: Other Options on Request/Customized: **Finish** (BR-Bronze, WH-White), **Accessories** (3RP-3 Pin Rotating Photocell, 3NP-3 Pin No Photocell, 3NT- 3 Pin No Rotating Shorting Cap, 5RP-5 Pin Rotating Photocell, 5NP-5 Pin No Photocell, 5NT- 5 Pin No Rotating Shorting Cap, 7RP-7 Pin Rotating Photocell, 7NP-7 Pin No Photocell, 7NT- 7 Pin No Rotating Shorting Cap, 10SP-Surge Protection, 20SP-Surge Protection, AM-Slip Fitter Mounting Bracket, FM- Flood Mounting)