

ITEM SKU#: 662187512525

# Dynamo 4 Pro

## Stadium Flood Light

INDUSTRIAL LIGHTING | FLOOD LIGHTS



### FEATURES

- Power selectability enables customized lighting levels for versatile applications.
- High-output illumination ensures powerful and uniform lighting across large arenas.
- Low EPA design reduces wind resistance, minimizing fixture stress and enhancing stability.
- Engineered for durability, the luminaire ensures reliable performance in challenging environments.
- Advanced dimming allows precise brightness control for optimal lighting.
- Built-in surge protection ensures enhanced reliability and stability during power fluctuations.
- DMX compatibility enables dynamic lighting control, including color-changing, grouping, scheduling, and remote operation.
- Optional visor and laser pointer for enhanced precision and glare control.

### APPLICATIONS

Stadiums and Sports Venues, Outdoor Advertising, Gymnasiums, Plazas, Airports, Courtyards, Public Areas, Ports

### PRODUCT DETAILS

#### ELECTRICAL

Max Power	1194.2W
Voltage	120-277V
Current	4.79A
Power Factor	0.9
Total Harmonic Distortion (THD)	20%
Surge Protection	L/N-PE: 10kV, L-N: 6kV

#### LIGHTING PERFORMANCE

Lumens	110760lm-147680lm-176363lm
Efficacy	147.68lm/W
Color Temperature (CCT)	5000K
Color Rendering (CRI)	72
R9 (Red Value)	-33
R13 (Skin Tones)	71
Beam Angle	40°
Light Distribution	NEMA:4 (NEMA:5/NEMA:6: Optional)
BUG Rating (Backlight, Uplight, and Glare)	B5-U0-G5
Dimmable Lighting Control	Continuous Dimming to 10% or Below

Notes:  
 \*Mentioned lumen output is calculated as such: 110760lm at 750W, 147680lm at 1000W, 176363lm at 1194.2W.  
 \*Fixtures mustn't be mounted facing upwards; it won't be covered under warranty.

### ENVIRONMENT

Operating Temperature	-40°F ~ +113°F
Suitable Location	<b>WET</b>
Ingress Protection Rating (IP)	IP65
Impact Protection Rating (IK)	IK08

### LIFESPAN

Average Life (Hours)	100,000
Warranty (Years)	<b>10</b>

### COMPONENTS

LED Light Source	Bridgelux SMD3030
Driver	Inventronics EUM-680S350MT

### CONSTRUCTION

Housing	Die-cast Aluminum
Cover Material / Lens	Polycarbonate
Diffuser	Clear
Power Supply	Hard Wired
Finish	Black (Bronze, White: Optional)
Effective Projected Area (EPA)	3.04ft²
Wind Sharing Rating	1.2mph

### PART NUMBER & QUALIFICATIONS

Ordering Part Number	IK-SP06B-1200/1000/750W-E1PS4MV-50K-BL-SH-20SP-FM
Qualified Part Number	IK-SP06B-1200/1000/750W-E1PS4MV-[BR, WH, BL] [3RP, 3NP, 3NT, 5RP, 5NP, 5NT, 7RP, 7NP, 7NT or blank][10SP, 20SP or blank][AM, FM or blank]50
SKU Number	662187512525



Not all product variations listed on this page are DLC qualified. Visit <https://www.designlights.org/pl> to confirm qualification.

**DIMENSIONS AND WEIGHT (SLIP FITTER MOUNT)**

Width (Inches)	31.67"
Height (Inches)	30.06"
Diameter (Inches)	20.51"
Net Weight (lbs)	70.98

**DIMENSIONS AND WEIGHT (FLOOD MOUNT)**

Width (Inches)	31.67"
Height (Inches)	21.28"
Diameter (Inches)	20.51"
Net Weight (lbs)	62.04

**PACKAGING**

SLIP FITTER & FLOOD MOUNT

Box Dimensions (Inches)	27.16" x 24.01" x 24.21"
Box Weight (lbs)	84.66 (Slip Fitter Mount) 75.68 (Flood Mount)
Quantity Per Box	1

Slip Fitter Mount

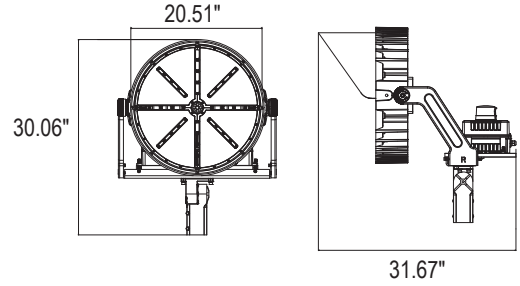

Flood Mount

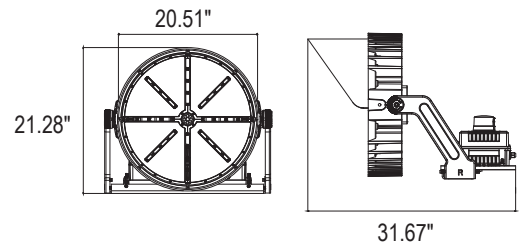

**SUPPORTING DOCUMENTS**

DOCUMENTS	DOCUMENT LINK
<a href="#">Product Sheet</a>	<a href="#">View / Download</a>
<a href="#">IES Files</a>	<a href="#">View / Download</a>
<a href="#">LM79 Report</a>	<a href="#">View / Download</a>
<a href="#">LM80 Report</a>	<a href="#">View / Download</a>
<a href="#">Installation Instructions</a>	<a href="#">View / Download</a>

**ORDERING INFORMATION**

SKU NUMBER	DESCRIPTION	QUANTITY/BOX
662187512525	DYNAMO 4 PRO SFL: 1194.2W / 110760-147680-176363LM / 5000K / 120-277V / BLACK	1

**ACCESSORIES**

INCLUDED IN THE BOX

SKU NUMBER	PRODUCT CODE	DESCRIPTION	DOCUMENT LINK
662187507651	IK-ACC-SP06B-750/1000/1200W-FM	FLOOD MOUNTING BRACKET	<a href="#">View / Download</a>
662187507743	IK-ACC-SP06B-750/1000/1200W-SH	SHIELD	<a href="#">View / Download</a>
662187487625	IK-ACC-SPD-20KV-(100-277V)	SURGE PROTECTION 20kV (100-277V)	<a href="#">View / Download</a>

## ACCESSORIES

### SOLD SEPARATELY

SKU NUMBER	PRODUCT CODE	DESCRIPTION	DOCUMENT LINK
662187507651	IK-ACC-SP06B-750/1000/1200W-FM	FLOOD MOUNTING BRACKET	<a href="#">View / Download</a>
662187487946	IK-ACC-SP06B-750/1000/1200W-SF	SLIP FITTER MOUNTING BRACKET	<a href="#">View / Download</a>
662187507743	IK-ACC-SP06B-750/1000/1200W-SH	SHIELD	<a href="#">View / Download</a>
662187482231	IK-PHC-3PIN-AC100-277V	PHOTOCELL (3 PIN) AC100-277V	<a href="#">View / Download</a>
662187540160	IK-PHC-5PIN-AC100-277V	PHOTOCELL (5 PIN) AC100-277V	<a href="#">View / Download</a>
662187540177	IK-PHC-7PIN-AC100-277V	PHOTOCELL (7 PIN) AC100-277V	<a href="#">View / Download</a>
662187483634	IK-PHC-3PIN-SOCKET-0-480V	PHOTOCELL (3 PIN) SOCKET AC 0-480V	<a href="#">View / Download</a>
662187483641	IK-PHC-5PIN-SOCKET-0-480V	PHOTOCELL (5 PIN) SOCKET AC 0-480V	<a href="#">View / Download</a>
662187487755	IK-PHC-7PIN-SOCKET-0-480V	PHOTOCELL (7 PIN) SOCKET AC 0-480V	<a href="#">View / Download</a>
662187486543	IK-ACC-SPD-10KV-(100-277V)	SURGE PROTECTION 10kV (100-277V)	<a href="#">View / Download</a>
662187487625	IK-ACC-SPD-20KV-(100-277V)	SURGE PROTECTION 20kV (100-277V)	<a href="#">View / Download</a>

\*Choice of one accessory: Mounting Bracket (Slip Fitter or Flood Mount—either one) is included with the order. Contact your IKIO sales representative to buy replacement/additional Mounting Bracket.

**NOTE:** Other Options on Request/Customized: **Finish** (BR-Bronze, WH-White), **Accessories** (3RP-3 Pin Rotating Photocell, 3NP-3 Pin No Photocell, 3NT- 3 Pin No Rotating Shorting Cap, 5RP-5 Pin Rotating Photocell, 5NP-5 Pin No Photocell, 5NT- 5 Pin No Rotating Shorting Cap, 7RP-7 Pin Rotating Photocell, 7NP-7 Pin No Photocell, 7NT- 7 Pin No Rotating Shorting Cap, 10SP-Surge Protection, 20SP-Surge Protection, AM-Slip Fitter Mounting Bracket, FM- Flood Mounting)