

ITEM SKU#: 662187511948

Luminix Stadium Flood Light

INDUSTRIAL LIGHTING | FLOOD LIGHTS



FEATURES

- Power selectability provides on-site lumen adjustment to suit varying athletic lighting requirements, from practice fields to tennis courts and other fields.
- High lumen performance combined with exceptional efficacy supports energy-efficient illumination across demanding applications.
- Streamlined low EPA profile minimizes wind load, reducing structural stress and supporting long-term fixture stability.
- Compatible DMX control supports advanced features including color tuning, zoning, scheduling, and remote system operation.
- Equipped with 0–10V dimming for precise light level control and integrated surge protection to ensure stable performance in fluctuating electrical conditions.
- IP65-rated construction supports outdoor durability, making it ideal for wet locations and harsh environmental conditions.
- Optional visor and laser accessory (sold separately) available for enhanced glare control and precise fixture aiming.

APPLICATION AREAS

Stadiums and Sports Venues, Outdoor Advertising, Gymnasiums, Plazas, Airports, Courtyards, Public Areas, Ports

PRODUCT DETAILS

ELECTRICAL

Max Power	799.7W
Voltage	277-480V
Current	1.16A-1.39A-1.62A-1.85A
Power Factor	0.9
Total Harmonic Distortion (THD)	15%
Surge Protection	L/N-PE: 10kV, L-N: 6kV

LIGHTING PERFORMANCE

Lumens	75885lm-91062lm-106239lm-121365lm
Efficacy	151.77lm/W
Color Temperature (CCT)	4000K
Color Rendering Index (CRI)	72
R9 (Red Value)	-41
R13 (Skin Tones)	70
Beam Angle	20° (Optional: 15° 35°)
Light Distribution	NEMA:4
BUG Rating (Backlight, Uplight, and Glare)	B5-U0-G3
Dimmable Lighting Control	Continuous Dimming to 10% or Below

*Note: Mentioned lumen output is calculated as such: 75885lm at 500W, 91062lm at 600W, 106239lm at 700W, and 121365lm at 799.7W.

ENVIRONMENT

Operating Temperature	-40°F ~ +113°F
Suitable Location	WET
Ingress Protection Rating (IP)	IP65
Impact Protection Rating (IK)	IK08

LIFESPAN

Average Life (Hours)	100,000
Warranty (Years)	10

COMPONENTS

LED Light Source	Bridgelux SMD 3030
Driver	Inventronics- EUM-880S420MT

CONSTRUCTION

Housing	Die-cast Aluminum
Cover Material / Lens	Polycarbonate
Diffuser	Clear
Power Supply	Hard Wired
Finish	Black (Bronze & Gray: Optional)
Effective Projected Area (EPA)	2.7ft ²
Wind Shear Rating	1.2mph

*Note: EPA values may vary based on the mounting bracket selected.

PART NUMBER & QUALIFICATIONS

Ordering Part Number	IK-SP11-800/700/600/500W-E1PD2HV-40K-BL-SH-20SP-FM
Qualified Part Number	IK-SP11-800/700/600/500W-E1PD2HV-[BR, WH, BL][10SP, 20SP or blank]["AM", "TM" or "FM"]40
SKU Number	662187511948



Note: Not all product variations listed on this page are DLC qualified. Visit <https://www.designlights.org/apl> to confirm qualification.

DIMENSIONS AND WEIGHT (SLIP FITTER MOUNTING BRACKET)

Length (Inches)	23.66"
Width (Inches)	16.85"
Height (Inches)	18.18"
Net Weight (lbs)	40.78

DIMENSIONS AND WEIGHT (FLOOD MOUNTING BRACKET)

Length (Inches)	26.22"
Width (Inches)	18.70"
Height (Inches)	13.77"
Net Weight (lbs)	44.09

DIMENSIONS AND WEIGHT (YOKE MOUNTING BRACKET)

Length (Inches)	23.66"
Width (Inches)	17.20"
Height (Inches)	17.24"
Net Weight (lbs)	42.32

PACKAGING**SLIP FITTER MOUNTING BRACKET, FLOOD MOUNTING BRACKET & YOKE MOUNTING BRACKET**

Box Dimensions (Inches)	27.55" x 15.74" x 11.81"
Box Weight (lbs)	46.29
Quantity Per Box	1

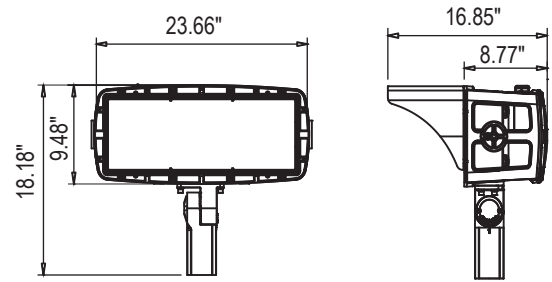
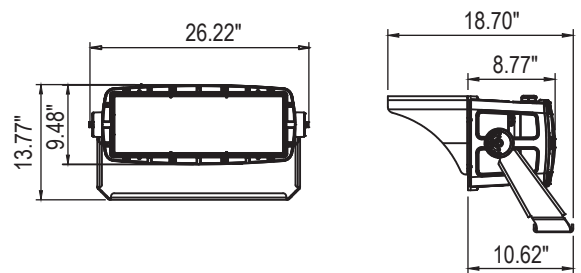
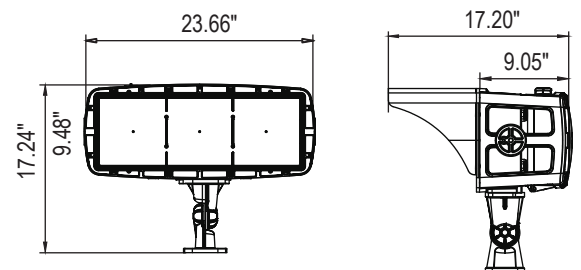
Slip Fitter Mounting Bracket**Flood Mounting Bracket****Yoke Mounting Bracket****SUPPORTING DOCUMENTS**

DOCUMENTS	DOCUMENT LINK
Product Sheet	View / Download
IES Files	View / Download
LM79 Report	View / Download
LM80 Report	View / Download
Installation Instructions	View / Download

ORDERING INFORMATION

SKU NUMBER	DESCRIPTION	QUANTITY/BOX
662187511948	LUMINIX SFL: 799.7W / 75885-91062-106239-121365LM / 4000K / 277-480V / BLACK	1

ACCESSORIES

INCLUDED IN THE BOX

SKU NUMBER	PRODUCT CODE	DESCRIPTION	DOCUMENT LINK
662187507781	IK-ACC-SP11-FM	FLOOD MOUNTING BRACKET	View / Download
662187507644	IK-ACC-SP11-500/600/700/800W-SH	SHIELD	View / Download
662187488516	IK-ACC-SPD-20kV-(277-480V)	SURGE PROTECTION 20kV (277-480V)	View / Download

ACCESSORIES

SOLD SEPARATELY

SKU NUMBER	PRODUCT CODE	DESCRIPTION	DOCUMENT LINK
662187507774	IK-ACC-SP11-SF	SLIP FITTER MOUNTING BRACKET	View / Download
662187507781	IK-ACC-SP11-FM	FLOOD MOUNTING BRACKET	View / Download
662187509273	IK-ACC-SP11-YM	YOKE MOUNTING BRACKET	View / Download
662187507644	IK-ACC-SP11-500/600/700/800W-SH	SHIELD	View / Download
662187487663	IK-PHC-3PIN-AC277-480V	PHOTOCELL (3 PIN) AC 277V-480V	View / Download
662187487717	IK-PHC-5PIN-AC277-480V	PHOTOCELL (5 PIN) AC 277V-480V	View / Download
662187487724	IK-PHC-7PIN-AC277-480V	PHOTOCELL (7 PIN) AC 277V-480V	View / Download
662187483634	IK-PHC-3PIN-SOCKET-0-480V	PHOTOCELL (3 PIN) SOCKET AC 0-480V	View / Download
662187483641	IK-PHC-5PIN-SOCKET-0-480V	PHOTOCELL (5 PIN) SOCKET AC 0-480V	View / Download
662187487755	IK-PHC-7PIN-SOCKET-0-480V	PHOTOCELL (7 PIN) SOCKET AC 0-480V	View / Download
662187507637	IK-ACC-SPD-10kV-(277-480V)	SURGE PROTECTION 10kV (277-480V)	View / Download
662187488516	IK-ACC-SPD-20kV-(277-480V)	SURGE PROTECTION 20kV (277-480V)	View / Download

*Choice of one accessory: Mounting Bracket (Slip Fitter Mount, Flood Mount, or Yoke Mount—either one) is included with the order. Contact your IKIO sales representative to buy a replacement or additional Mounting Bracket.

NOTE: Other Options on Request/Customized: **Finish** (BR-Bronze, WH-White), **Accessories** 10SP-Surge Protection, 20SP-Surge Protection, AM-Slip Fitter Mounting Bracket, TM-Yoke Mounting Bracket, FM- Flood Mounting Bracket)