



## Amparo Area Luminaire

### FEATURES

- Exceptional efficacy (140 lm/W).
- 100,000 hours of lifetime.
- Superior thermal dissipation due to integrated heat sink.
- Simple and quick installation with the quick mount bracket and hinged door frame.
- Integrated surge protection mechanism. Can withstand a maximum peak voltage of 25 kV
- Dark Sky Compliant
- IK10 Rated

### PRODUCT DETAILS

#### LIGHTING PERFORMANCE

<b>Efficacy</b>	140 lm/W				
<b>Power</b>	100 W	150 W	190 W	300 W	400 W
<b>Lumen Output</b>	14000 lm	21000 lm	26600 lm	42000 lm	56000 lm
<b>CCT</b>	3000 K, 3500 K, 4000 K, 4500 K, 5000 K, 5700 K				
<b>CRI</b>	80+				
<b>Voltage</b>	AC 100-277 V 50/60 Hz (also available with 240 - 480 V input)				
<b>Distribution</b>	Pointing Straight Down Only				
<b>Power factor</b>	≥ 0.90				
<b>Dimming</b>	Continuous Dimming to 10% or below (0-10V)				

#### ENVIRONMENT & LIFESPAN

<b>Operating Temperature</b>	-40° F to +131° F
<b>IP Rating</b>	IP66
<b>Operating Hours</b>	Over 100,000 hours life at L70
<b>Warranty</b>	10 Years
<b>BUG Rating</b>	150W : B3-U0-G3, 300W : B4-U4-G4
<b>IK Rating</b>	IK10
<b>Dark Sky Compliant</b>	Yes
<b>Total Harmonic Distortion</b>	14.1%

#### CONSTRUCTION

<b>Housing</b>	Aluminum + Polycarbonate (Optics)
<b>Base / Power Supply</b>	Hard Wired
<b>Finish</b>	Bronze / White / Grey / Black / Custom
<b>Effective Projected Area</b>	150W : 0.23 sq ft, 300W : 0.42 sq ft
<b>Wind Shear Rating</b>	116.8 mph

#### APPLICATIONS

Parking lot, street and building perimeter lighting. Can also be used as flood or area light.

#### QUALIFICATIONS & WARRANTY



### DIMENSIONS

Wattage	A(in)	B(in)	C(in)
100 W, 150 W, 190 W	18	14	7
300 W	24	14	7
400 W	30.12	11.88	4.08

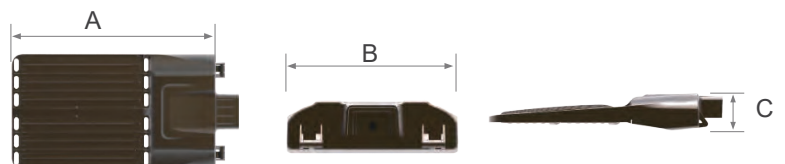

**ORDERING INFORMATION**

MODEL	POWER	CCT	VOLTAGE	DISTRIBUTION	MOUNTING BRACKET	ADAPTER	ACCESSORIES
IK-SBSL2-L130	0100A	3000K	MV	T2M	A	SFA	S
	0100A	3000K	MV - 100-277V	T2M	A - Slip Fitter	SFA- Slip Fit Adapter	S - Shorting Cap
	0150A	3500K	HV - 240-480V	T3S	B - Square & Round	NO - None	P - Photocell
	0190A	4000K		T3M	C - Trunnion		SP - Smart Photocell
	0300A	4500K		T4S	D - Flood		PDH - Photocell with Day Light Harvesting
	0400A	5000K		T5M	F - Wall		
		5700K		90X120			

**FINISH**

BZ

BZ - Bronze

W - White

BL - Black

G - Grey

\*Mounting Bracket and Shorting Cap / Photocell are included with the order at no extra cost.

Example Part Number - IK-SBSL2-L130-0100A-3000K-MV-T2M-A-SFA-S-BZ

**PACKAGING**

Quantity Per Box 1

Box Dimensions -----

Box Weight -----

**ACCESSORIES / REPLACEMENT PARTS**

S - SHORTING CAP (IK-SBSL/2-S4C-90-480V)

P - PHOTOCCELL (IK-SBSL/2-PHC-90-277V, IK-SBSL/2-PHC-200-480V)

100W/150W/190W/400W WATT DIMMABLE LED REPLACEMENT DRIVER

SFA - QUICK-MOUNT SLIP FITTER ADAPTER (IK-SF-A)

PDH - PHOTO CONTROL WITH DAY LIGHT HARVESTING CAPABILITY

SP - SMART PHOTO CELL: TO CONTROL FIXTURE VIA IKIO WIRELESS CONTROL SYSTEM IOS/ANDROID/ WINDOWS APP

**MOUNTING OPTIONS**

BRACKET- A Slip Fitter Pole Mount	BRACKET- B Square & Round Pole Mount	BRACKET- C Trunnion T Bar Pole Mount	BRACKET- F Wall Mount	BRACKET- D Flood Mount
				
IK-SBSL2-SF-A	IK-SBSL2-SP-B	IK-SBSL2-TR-C	IK-SBSL2-WM-F	IK-SBSL2-FM-D

**DISTRIBUTION DIAGRAM**

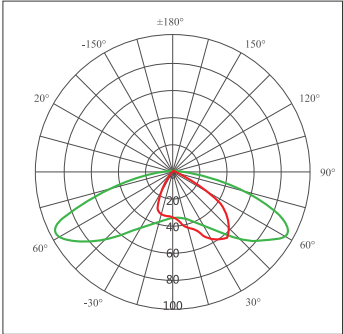

Type 2-M

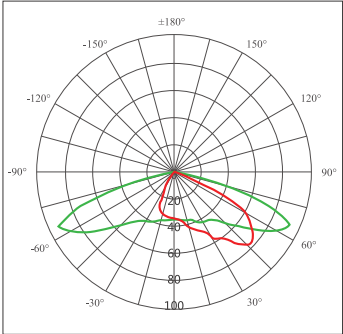

Type 3-S

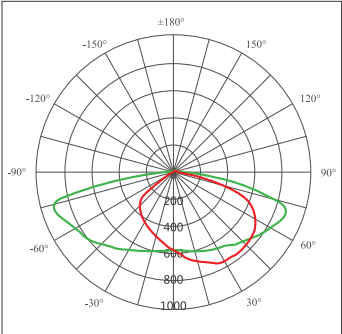

Type 3-M

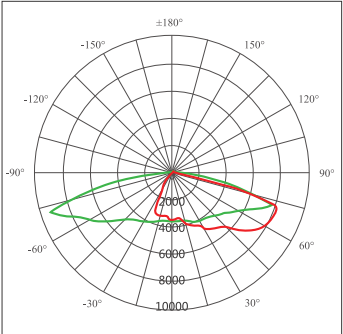

Type 4-S

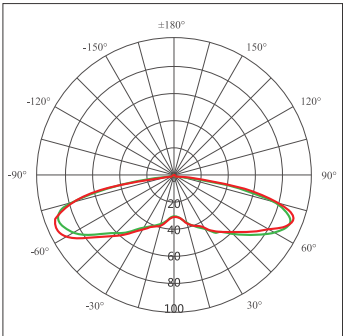

Type 5-M

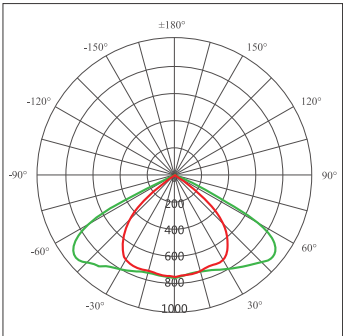

90 x 120

### ⚠ WARNING:

1. To avoid the risk of fire, explosion or electric shock, this product should be installed, inspected, and maintained by a qualified electrician only, in accordance with all the applicable electrical codes.
2. Be certain that the electrical power is switched off before and during its installation and maintenance.
3. The luminaire must be connected to a wiring system with an equipment-grounding conductor.
4. Make sure the supply voltage is the same as the rated luminaire voltage.
5. Do not install where the marked operating temperatures exceed the ignition temperature of the hazardous atmosphere.
6. Do not operate in ambient temperatures above those indicated on the luminaire nameplate.
7. Keep the lens tightly closed when in operation.
8. For supply connections use wire rated for at least 90° C.

## Installation Instructions

BRACKET-A



BRACKET-B



BRACKET-C



BRACKET-F



BRACKET-D



### Arm Mount

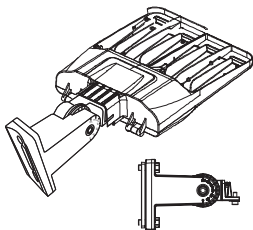

Rubber ring for square pole

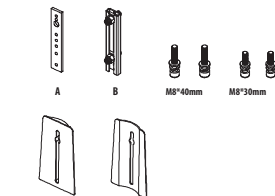

Rubber ring for round pole

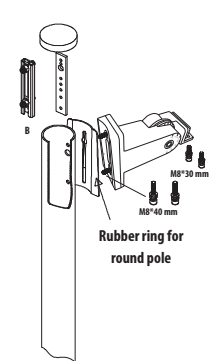
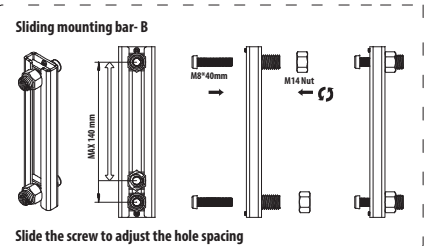
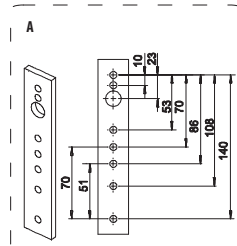

Circular pole mounting (installation)

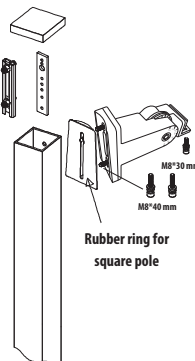

Square pole mounting (installation)

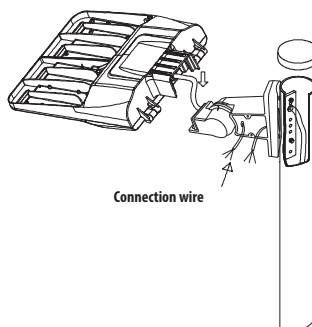

Connection wire

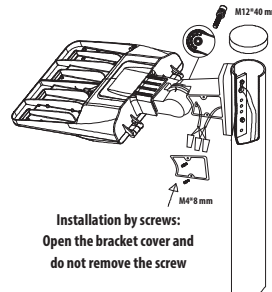

Installation by screws:  
Open the bracket cover and do not remove the screw

Wiring solution 1

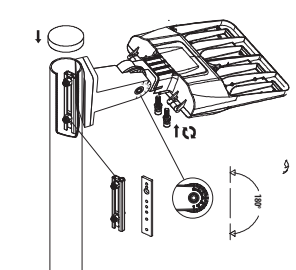

Wiring solution 2

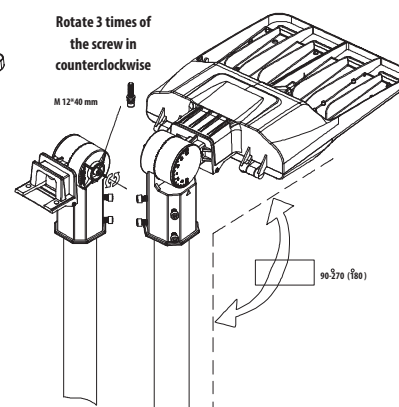
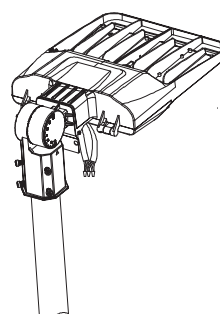
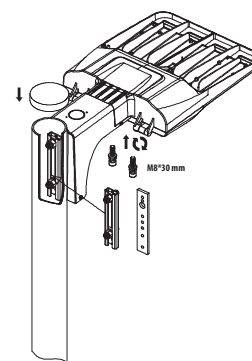
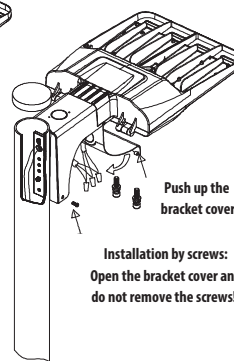
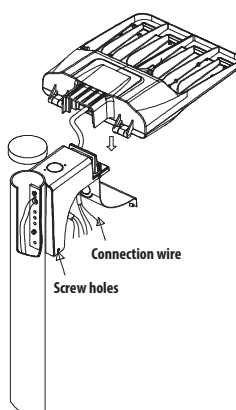
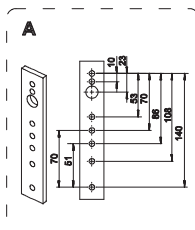

## BRACKET C - Trunnion (Trunnion T Bar Pole Mount)

### OPTION 1

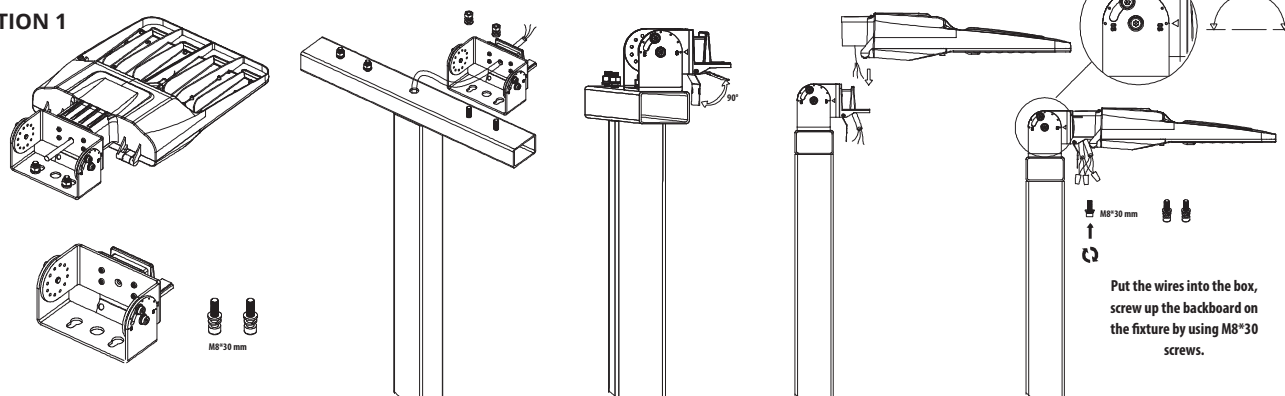

### OPTION 2

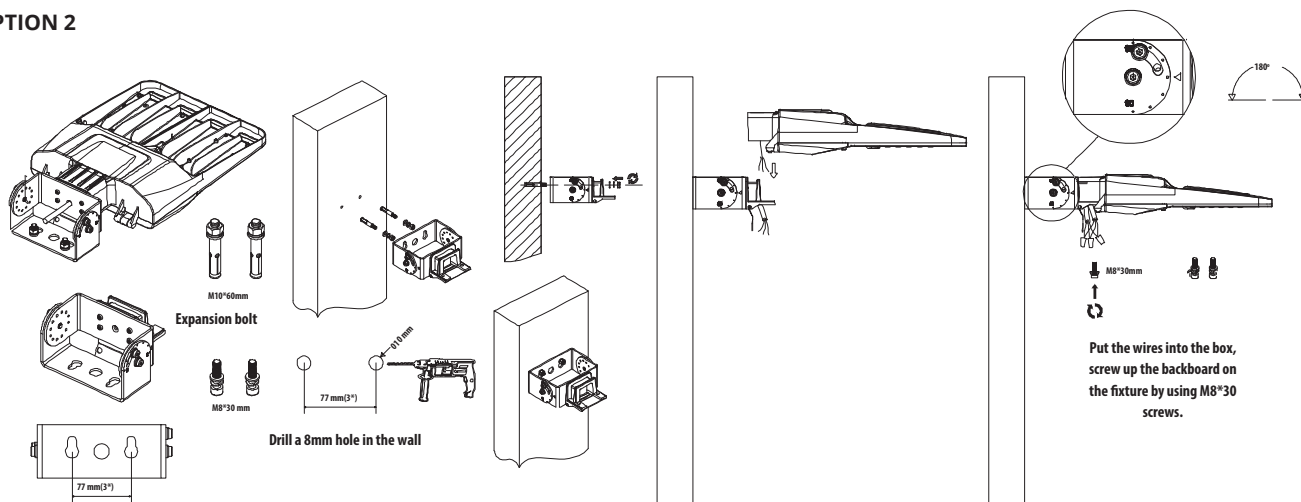

## Photocell / Motion Sensor Demonstration Drawing For Installation.

### DEMONSTRATION PLAN 1

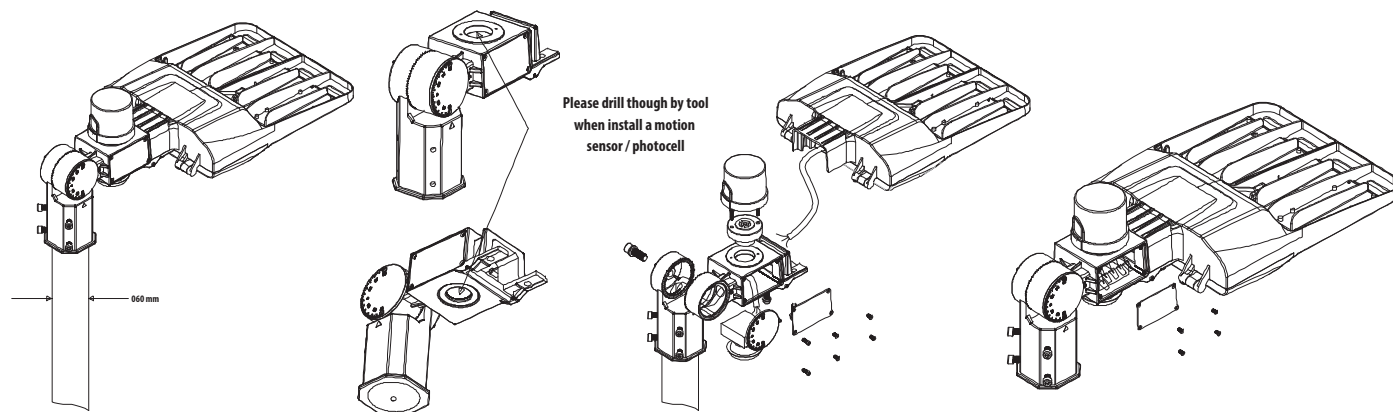

## DEMONSTRATION PLAN 2

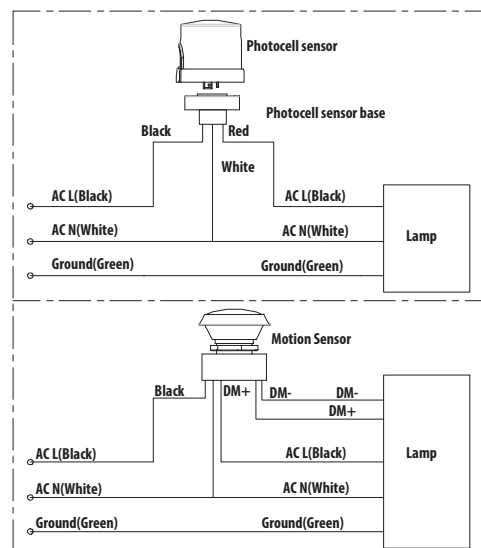
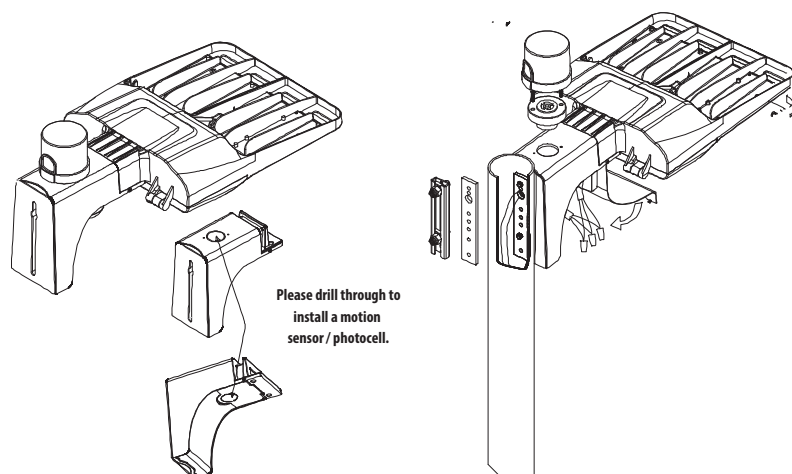

### After installation, please

1. Check whether the lighting fixture is firmly fixed.
2. Check whether wires are connected correctly.
3. At last, switch on the power, and check if the fixture works well. If not, please switch off the power and contact with local dealer.