



Locus Area Luminaire

FEATURES

- Exceptional efficacy (140 lm/W).
- 100,000 hours of lifetime.
- Excellent efficacy with an improved light output.
- Integrated surge protection mechanism. Can withstand a maximum peak voltage of 25 kV
- Superior thermal dissipation from an integrated heat sink.
- Dimming option available, mode - Voltage (1~10V DC) , PWM signal (10V) , Resistance (10K/N~100K/N Ohms).
- Dark Sky Compliant
- IK10 Rated

PRODUCT DETAILS

LIGHTING PERFORMANCE

Efficacy	140 lm/W				
Power	100 W	150 W	200 W	240 W	300 W
Lumen Output	14000 lm	21000 lm	28000 lm	33600 lm	42000 lm
CCT	3000 K, 3500 K, 4000 K, 4500 K, 5000 K, 5700 K				
CRI	80+				
Voltage	AC 100-277 V 50/60 Hz (also available with 240 - 480 V input)				
Distribution	Pointing Straight Down Only				
Power factor	≥ 0.90				
Dimming	Continuous Dimming to 10% or below (0-10V)				

ENVIRONMENT & LIFESPAN

Operating Temperature	-40° F to +120° F
IP Rating	IP66
Operating Hours	Over 100,000 hours life at L70
Warranty	10 Years
BUG Rating	150W : B3-U0-G3, 300W : B4-U4-G4
IK Rating	IK10
Dark Sky Compliant	Yes
Total Harmonic Distortion	14.1%

CONSTRUCTION

Housing	Aluminum + Polycarbonate (Optics)
Base / Power Supply	Hard Wired
Finish	Bronze / White / Grey / Black / Custom
Effective Projected Area	150W : 0.23 sq ft, 300W : 0.42 sq ft
Wind Shear Rating	116.8 mph

APPLICATIONS

Parking lot, street and building perimeter lighting. Can also be used as flood or area light.

QUALIFICATIONS & WARRANTY



DIMENSIONS

Wattage	A(in)	B(in)	C(in)
100 W - 150 W	16.80	11.88	3.36
200 W - 300 W	23.40	11.88	3.60

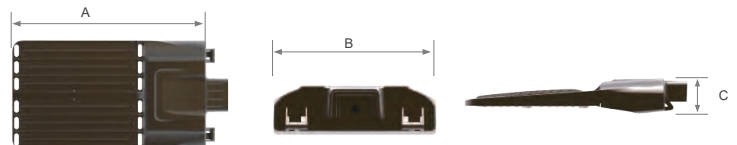

ORDERING INFORMATION

MODEL	POWER	CCT	DIMMING	NUMBER OF MODULES	VOLTAGE	DISTRIBUTION
IK-SBSL1 -	0100 -	30 -	DY -	RLV01 -	MV -	T2M -
	0100	30- 3000K	DY-Dimmable	RLV01	MV - 100-277V	T2M
	0150	35- 3500K	DN- Non Dimmable	RLV02	HV - 240-480V	T3S
	0200	40- 4000K				T3M
	0240	45- 4500K		RLV01 - for 100W - 150W		T4S
	0300	50- 5000K		RLV02 - for 200W - 300W		T5M
		57- 5700K				90X120

MOUNTING BRACKET	ADAPTER	ACCESSORIES	FINISH
A -	SFA -	S -	BZ -
A - Slip Fitter	SFA- Slip Fit Adapter	S - Shorting Cap	BZ - Bronze
B - Square & Round		P - Photocell	W - White
C - Trunnion	NO - None	SP - Smart Photocell	BL - Black
D - Flood		PDH - Photocell with Day Light Harvesting	G - Grey
F - Wall			

*Mounting Bracket and Shorting Cap / Photocell are included with the order.

Example Part Number - IK-SBSL1-0100-30-DY-RLV01-MV-T3M-A-SFA-S-BZ

PACKAGING

Quantity Per Box	1
Box Dimensions	100W/150W - 18.11" X 13.78" X 5.70" 200W/240W/300W - 26" X 13.78" X 5.70"
Box Weight	

ACCESSORIES / REPLACEMENT PARTS

S - SHORTING CAP (IK-SBSL/2-S4C-90-480V)

P - PHOTOCELL (IK-SBSL/2-PHC-90-277V, IK-SBSL/2-PHC-200-480V)

150W NON DIMMABLE LED REPLACEMENT DRIVER

SFA - QUICK-MOUNT SLIP FITTER ADAPTER (IK-SF-A)

PDH - PHOTO CONTROL WITH DAY LIGHT HARVESTING CAPABILITY

SP - SMART PHOTO CELL: TO CONTROL FIXTURE VIA IKIO WIRELESS CONTROL SYSTEM IOS/ANDROID/ WINDOWS APP

MOUNTING OPTIONS

BRACKET - A Slip Fitter Pole Mount	BRACKET - B Square & Round Pole Mount	BRACKET - C Trunnion T Bar Pole Mount	BRACKET - F Wall Mount	BRACKET - D Flood Mount
				
IK-SBSL1-SF-A	IK-SBSL1-SP-B	IK-SBSL1-TR-C	IK-SBSL1-WM-F	IK-SBSL1-FM-D

DISTRIBUTION DIAGRAM

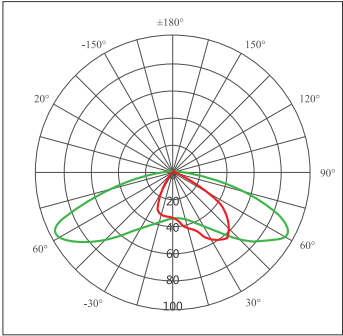

Type 2-M

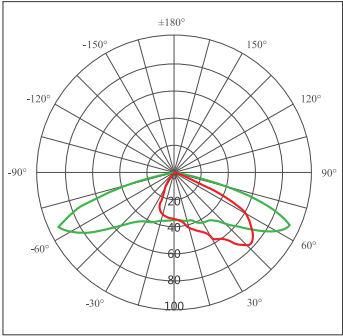

Type 3-S

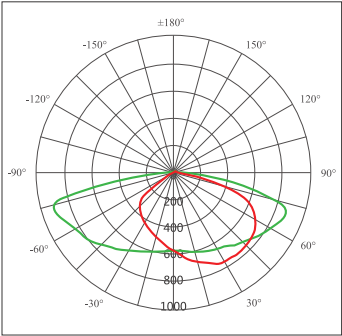

Type 3-M

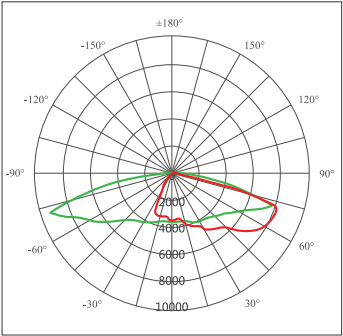

Type 4-S

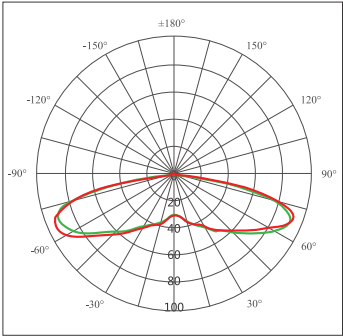

Type 5-M

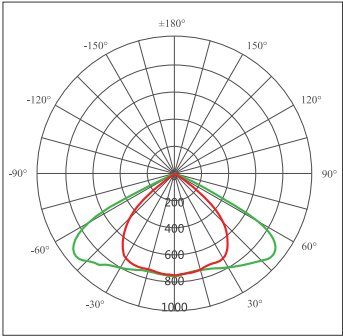

90 x 120

IMPORTANT SAFEGUARDS

PLEASE FIND A QUALIFIED ELECTRICIAN FOR INSTALLATION. Please read the instructions before you install and use the luminaire.
WARNING, CAUTIONS AND OPERATING INSTRUCTIONS

- To reduce the risk of death, personal injury or property damage from fire, electric shock, falling parts, cuts/abrasions, and other hazards read all warnings and instructions included with and on the fixture box and all fixture labels.
- Before installing, servicing, or performing routine maintenance upon this equipment, follow these general precautions.
- Commercial installation, service and maintenance of luminaires should be performed by a qualified licensed electrician.
- For The installation: If you are unsure about the installation or maintenance of the luminaires, consult a qualified licensed electrician and check your local electrical code.
- To prevent wiring damage or abrasion, do not expose wiring to edges of sheet metal or other sharp objects.
- Do not make or alter any open holes in an enclosure of wiring or electrical components during kit installation.
- Do not cover any part of the fixture; this can cause overheating.

WARNING: RISK OF FIRE OR ELECTRICAL SHOCK

- Turn off electrical power at fuse or circuit breaker box before wiring fixture to the power supply.
- Turn off the power when you perform any maintenance.
- Verify that supply voltage is correct by comparing it with the luminaire label information.
- Make all electrical and grounded connections in accordance with the National Electrical Code and any applicable local code requirements.
- All wiring connections should be capped with UL approved wire connectors.

CAUTION: RISK OF INJURY

- Avoid direct eye exposure to the light source while it is on.
- Account for small parts and destroy packing material, as these may be hazardous to children.
- Suitable for Wet locations, IP65.

! WARNING DISCONNECT POWER BEFORE INSTALLING OR SERVICING.

TRUNNION MOUNTING (POLE)

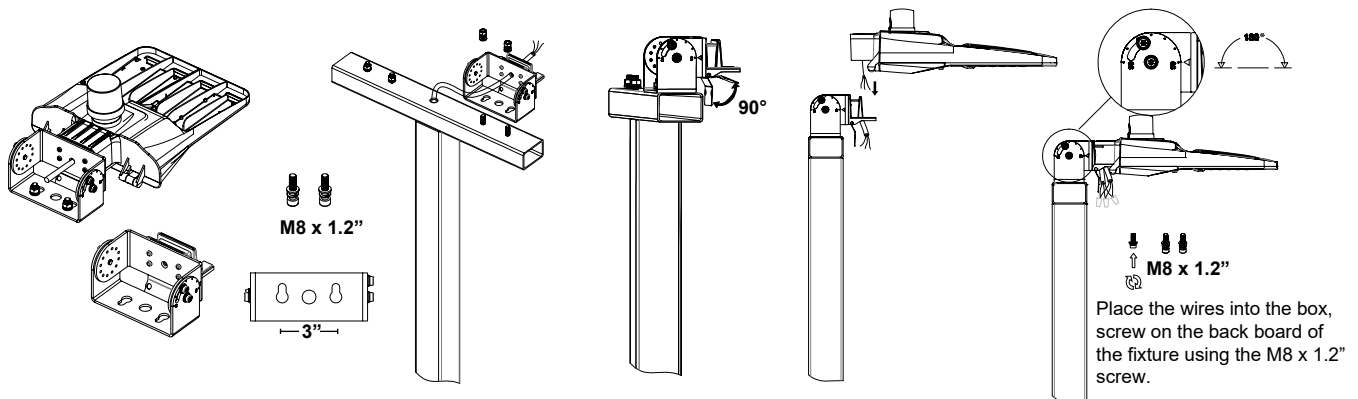

TRUNNION MOUNTING (WALL)

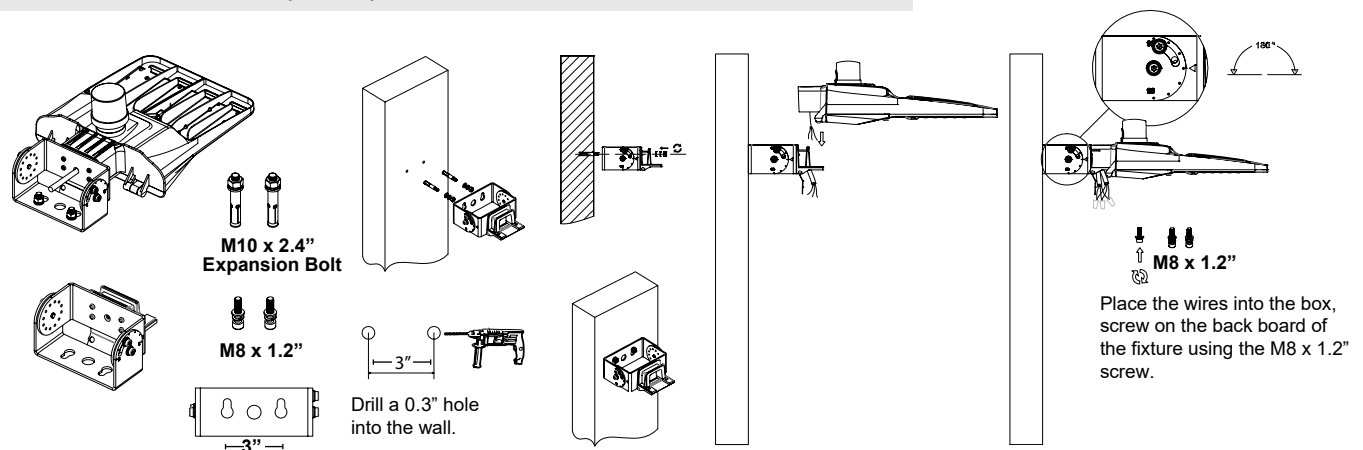

LOCUS AREA LUMINAIRE

SLIP FITTER MOUNTING

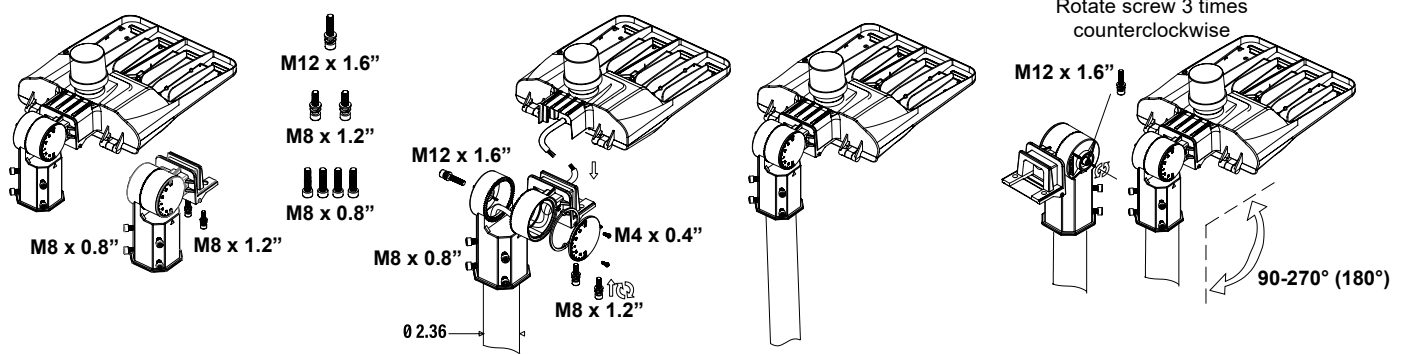

POLE MOUNTING

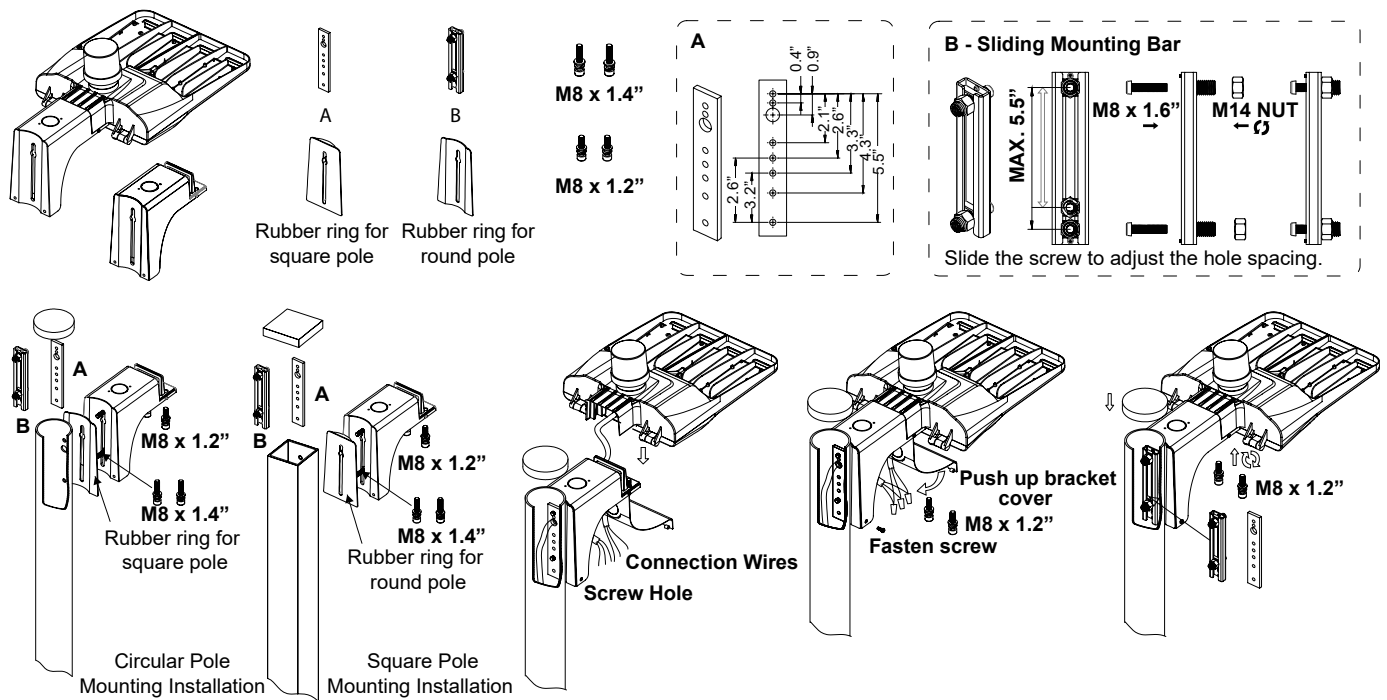

SENSOR INSTALLATION FOR POLE BRACKET

