

T5 TUBE – TYPE C

IMPORTANT SAFEGUARDS

READ CAREFULLY BEFORE INSTALLING. RETAIN THESE INSTRUCTIONS FOR FUTURE REFERENCE.

- **CAUTION** - Risk of fire or electric shock. Do not install this lamp in a pre-heat luminaire.
- **WARNING** - Risk of electric shock. Turn off electrical power at fuse or circuit breaker box.
- This product must be installed in accordance with applicable manufacturer installation instructions.
- Installation must be performed only by a licensed electrician in accordance with the National Electrical Code (NEC) and local electrical codes. Proper grounding is required for safety.
- **WARNING** - Test lamp before mass installation.
- **WARNING** - These lamps are not to be used with a light dimmer.
- **WARNING** - This device is not intended for use with emergency exits.
- This lamp can be used indoors or outdoors. (damp locations rated).
- **CAUTION** - If the lamp or luminaire exhibits undesirable operation (buzzing, flickering, etc.), immediately turn off power, remove the lamp from luminaire and contact the manufacturer.

! WARNING DISCONNECT POWER BEFORE INSTALLING OR SERVICING.

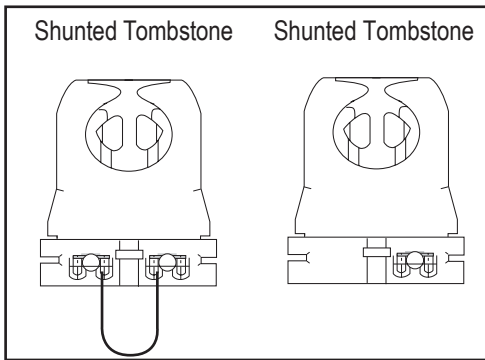

Note: Tombstone wiring should have one side Hot (L) and other side Neutral (N). Tombstones may vary based on what is currently installed in the fixture.

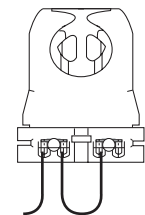

Non-Dimmable

Input		Output	
Wire Color	Assignment	Wire Color	Assignment
Red	AC L	Red	LED 1 +
Black	AC N	Black	LED 1 -

INSTALLATION INSTRUCTIONS:

- I. Shunted tombstones are required for installation.
 - Note: If tombstone is a non-shunt type, convert it to a shunted tombstone.
- II. Ballast must be removed and replaced with LED driver
 1. Turn off the power to the light fixture at the breaker panel before installation.
 2. Open the diffuser of the light fixture.
 3. Remove the fluorescent tubes. Please dispose of these items properly as they contain mercury.
 4. Remove wiring channel cover.
 5. Remove the existing ballast and install the external LED driver in place of the ballast.
 6. Connect to input end of the LED driver: connect AC power to the red wire (AC L [Hot or Live]) and the neutral to the black wire (AC N [Neutral]).
 7. Connect the output end of the external LED driver so that one end of the fixture connects to the (Neutral) black wire (LED-) and other end connects to the (Live or Hot) red wire (LED+).
 8. Replace the cover over the wiring channel.
 9. Insert the LED tube(s) into the fixture, making sure the correct corresponding ends are installed in the neutral and live (Hot) ends.

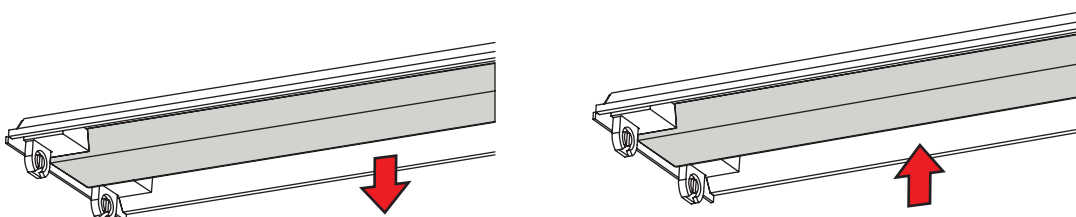

T5 TUBE – TYPE C

SINGLE TUBE INSTALLATION DIAGRAM:

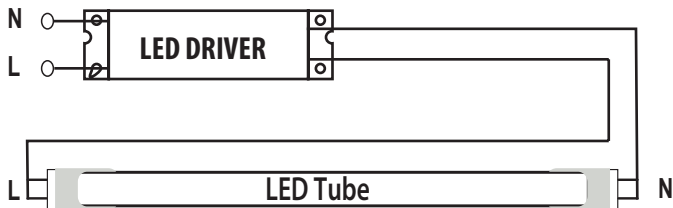

TWO TUBES INSTALLATION DIAGRAM:

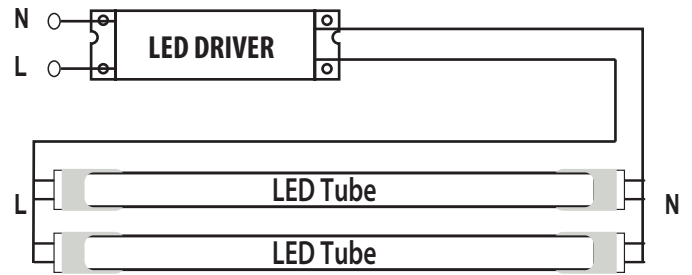

THREE TUBES INSTALLATION DIAGRAM:

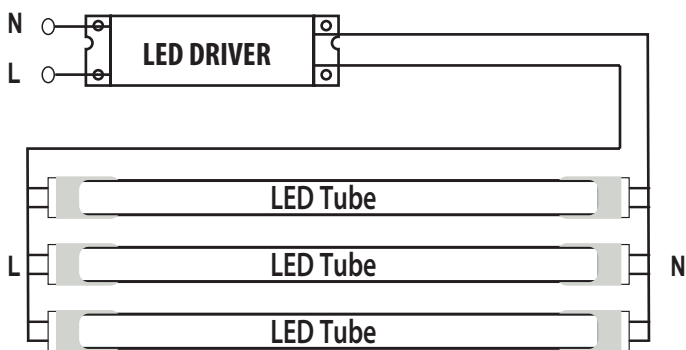

FOUR TUBES INSTALLATION DIAGRAM:

